

## GRAND CONFERENCING - CONFERENCE & EVENT CENTRE

### BASIC EQUIPMENT

- 1 projector/flatscreen TV
- 1 projection screen
- 1 flipchart
- 1 pinboard
- 1 notepad plus pencil per person
- 1 presenter's kit

### OUR NEW ROOMS

- A meeting room with a seminar table that can be transformed into a ping-pong table within a few seconds
- LED TVs with Click & Share System
- Whiteboards & pinboards
- Flipchart can also be used as table
- 1 presenter's kit

### HOTEL INFORMATION

- Number of rooms: 225
- **86 MODERNISED ROOMS**
- Comfort double rooms: 86
- Comfort deluxe rooms: 68
- Superior double rooms: 59
- Junior suites: 5 (2-storeyed)
- Suites: 6
- Presidential Suite: 1
- Number of floors: 7

### EQUIPMENT

- Air conditioning, flatscreen TV, safe, table, telephone
- Wi-Fi internet access throughout the hotel free of charge (500 Mbit/s)
- 14 adjustable seminar and meeting rooms for up to 970 persons, partially with daylight
- Ballroom with natural light, 24 sqm stage and dance floor
- Handwerk Restaurant
- Joe's Bar with a wide range of Gin specialities
- Spacious spa & fitness area
- Hotel-own car park for 224 vehicles
- Bus parking opposite the hotel

## ROOMS & SEATING



ROOM	AREA in m <sup>2</sup>	LENGTH x WIDTH in m	HEIGHT in m	BANQUET	BLOCK	RECEPTION	PARLIAMENT	THEATRE	U-SHAPE	CIRCLE
Boheme	200	11 x 18,5	2,60-6,85	140	50	250	100	150	45	70
Arabella	130	7,5 x 18,5	2,60-6,85	90	40	180	60	70	30	50
Ernani	80	10,5 x 10	2,60	60	30	100	40	60	25	35
Don Giovanni	40	10,5 x 4	2,60	20	15	-	15	20	10	15
Figaro	40	10,5 x 4	2,60	20	15	-	15	20	10	15
Arabella/Boheme	330	18,5 x 18,5	2,60-6,85	250	70	400	220	350	60	140
Don Giovanni/Ernani/Figaro	180	10,3 x 18	2,60	100	30	230	60	80	25	45
Don Giovanni/Ernani	120	10,5 x 14	2,60	70	25	180	60	70	20	40
Figaro/Ernani	120	10,5 x 14	2,60	70	25	180	60	70	20	40
Wimberger Saal ground floor	510	29 x 18,5	2,60-6,85	400	-	700	350	450	-	-
Wimberger Saal 2-storeyed	760	29 x 18,5	2,60-6,85	600	-	900	400	600	-	-
Hamlet	90	10,3 x 9,1	2,30	60	30	120	40	50	25	35
Geneveva	40	8 x 4,75	2,30	20	15	40	15	20	10	15
Iphigenia	30	7 x 4,30	2,30	20	10	-	10	15	8	10
Geneveva/Hamlet/Iphigenia	180	10,3 x 18	2,30	100	30	220	60	80	25	45
Geneveva/Hamlet	130	10,3 x 13,8	2,30	80	25	180	60	70	20	40
Hamlet/Iphigenia	120	10,3 x 13,4	2,30	80	25	180	60	70	20	40
Lohengrin	42	6,9 x 6,5	2,30	-	14	-	15	20	10	15
Mephisto	23	7 x 3,3	2,30	-	8	-	-	-	-	-
Othello	23	5,2x4,5	2,30	-	6	-	-	-	-	-
Papageno	42	5,7x7,5	2,30	-	14	-	15	20	10	15
Presidential Suite	45	9 x 5	2,30	-	12	30	8	10	8	-
Suite	30	5 x 5	2,30	-	8	-	-	-	-	-
Business Suite 521	30	5 x 5	2,30	-	8	-	-	-	-	-
Foyer Exhibition Space	200	8,5 x 7,5	2,30-8,00	-	-	-	-	-	-	-
Spiegelsaal Exhibition Space	70	11 x 7	2,30	-	-	-	-	-	-	-

For further information, please see "Business & Conferences" on our website | [www.arcotelhotels.com](http://www.arcotelhotels.com)

## GROUND FLOOR

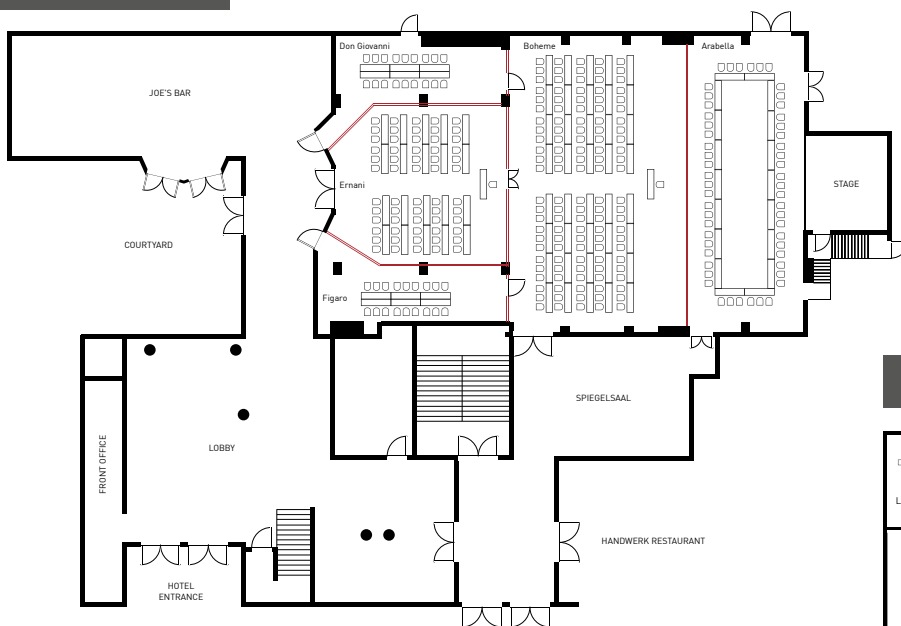

## FIRST FLOOR

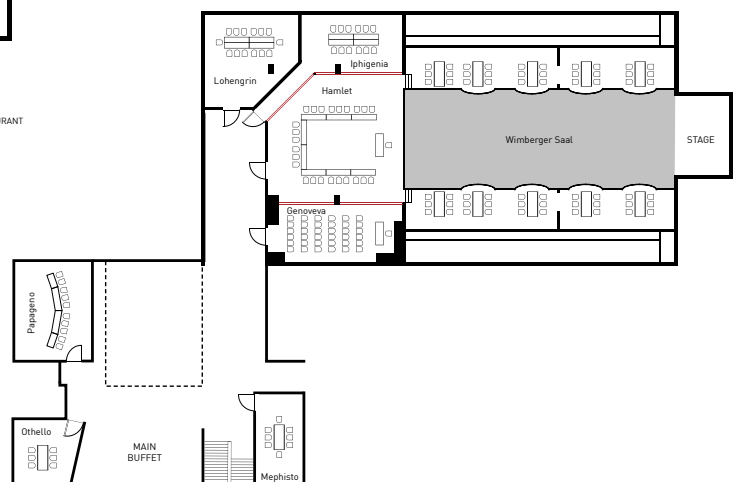

mobile element